

Which screws to use

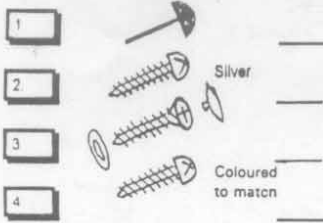

INSTRUCTIONS

LOTUS

FOLDING WALLS & DOORS PTY. LTD
 A.C.N. 007 087 523
 7/16 Milne Avenue, Seaford, Victoria, 3108
 Telephone (03) 786 7788 Fax (03) 786 7067

Packed & Quality Checked by : _____ on / /

Door _____
 Track _____
 Channel _____
 Pelmets _____
 Strap _____
 Fixings _____

Options _____
 Latch _____
 Latch & Privacy Snib _____
 Commercial key lock & key _____
 Aluminium Pelmets _____
 Aluminium Track _____

1. PELMETS

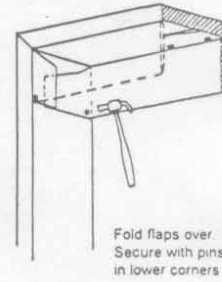
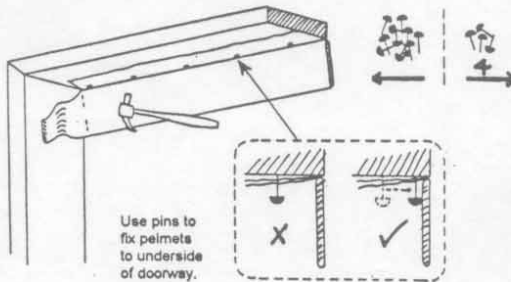
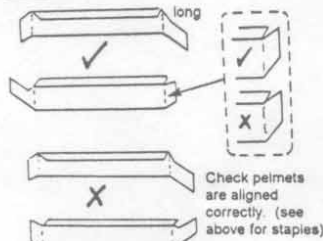

2. TRACK

Bunch up door and slide track over runners.

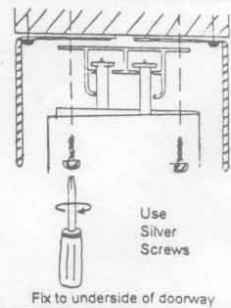
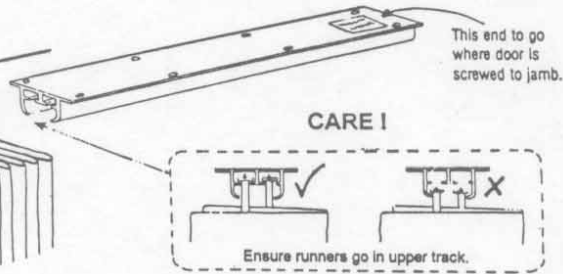
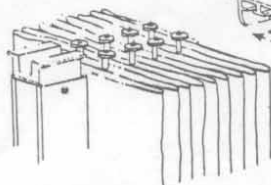

3. DOOR

Fix first half panel to frame

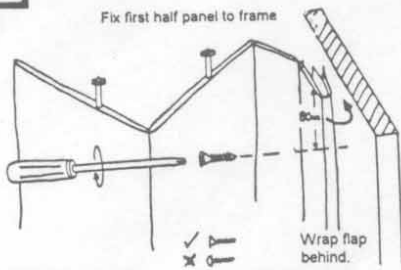

Fixing intervals:
 Start fixing 80mm from bottom and at intervals of approx. 300mm as shown.

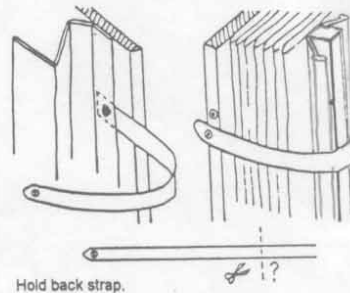
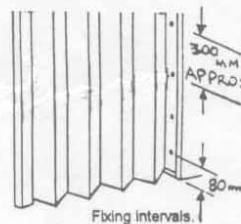

4. CHANNEL

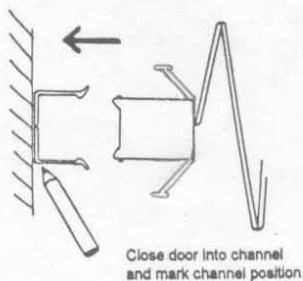
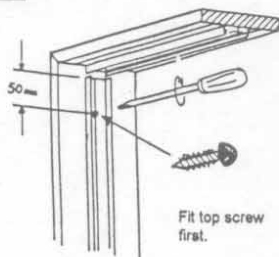

SEE OVER PAGE FOR FITTING OF OPTIONAL EXTRA LATCHES & LOCKS.

OPTIONAL EXTRAS

1. POSITIVE LATCH

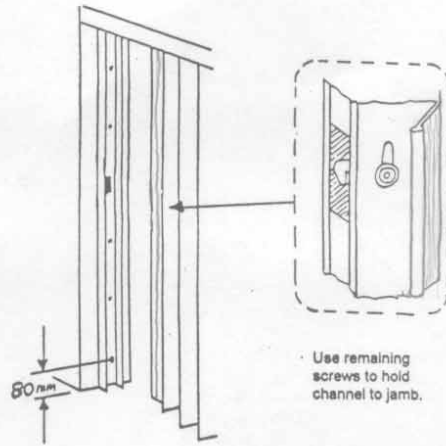
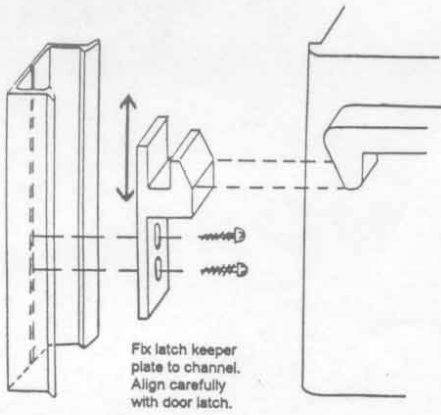

2. LATCH & PRIVACY SNIB

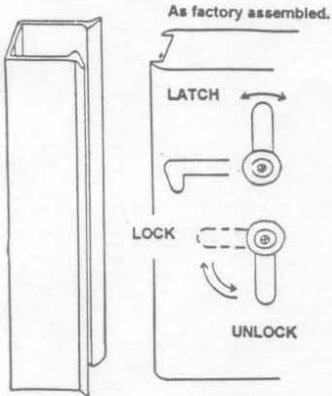

To change Privacy Snib side, follow this sequence carefully.

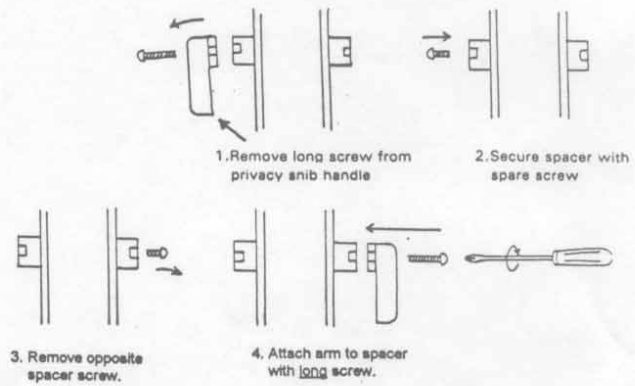

3. COMMERCIAL KEYLOCK

